

MANDATORY BULLETIN

MB No: L 13 AC/011a

Concerning: Maintenance Manual L-13AC BLANIK Sailplane (Do-L13AC-1032.3)

Reason: Addition of the Equipment / furnishing list.
Replace original pages 0-3, 0-8, 0-9, 0-11, 0-12, 0-15, 9-3, 9-24 by new ones and insert new pages 9-25, 9-26 with date June 6/02.

To be carried out at the latest by: Immediately after receiving this bulletin.
To be carried out by: Owner.
Costs to be covered by: No cost arise.
Necessary material to be supplied by: Revised pages are enclosed.
Bulletin becomes effective: Since receiving this bulletin.
Manhours required: -
Total number of pages: 1+8 enclosure pages.

Manufacturer

Engineering data contained in this Bulletin is CAA Approved.

Date: May 14, 2003

RECORD OF ISSUED BULLETINS

Serial. No. of Bull.	No. of Bulletin L 13 AC/	Issue date	Numbers of pages to which bulletin applies	Date of insertion in this issue and signature
1	L 13 AC/004d	Feb 18/00	0-3, 0-9, 3-29	
2	L 13 AC/005d	Aug 15/01	0-3, 0-7, 0-9, 0-12, 0-16, 13-1 to 13-10	
3	L 13 /096a	Sep 10/01	0-3, 0-7, 0-9, 2-5	
4	L 13 /098a	Jan 25/02	0-3, 0-7, 0-9, 3-14	
5	L 13 AC/006d	Feb 11/02	0-3, 0-7 to 0-14, 1-4 to 1-8, 3-5, 3-7, 3-10, 3-13, 3-14, 3-15, 3-17, 3-18, 3-25, 3-30, 5-3 to 5-7, 5-15 to 5-22, 7-3, 7-4, 7-17, 8-5, 8-8	
6	L 13 AC/011a	June 6/02	0-3, 0-8, 0-9, 0-11, 0-12, 0-15, 9-3, 9-24 to 9-26	

L - 13 AC BLANIK

MAINTENANCE MANUAL

Serial. No. of Bull.	No. of Bulletin L 13 AC/	Issue date	Numbers of pages to which bulletin applies	Date of insertion in this issue and signature

RECORD OF REVISIONS

Serial. No. of revision	Number of bulletin L 13 AC...	Numbers of Pages			Date of Revision	Date of insertion in this issue and signature
		Rev. Pages	New. Pages	Del. Pages		
1	L 13 AC/004d	0-3	-	-	Feb 18/00	
		0-7	-	-		
		0-9	-	-		
		3-29	-	-		
2	L 13 AC/005d	0-3	-	-	Aug 15/01	
		0-7	-	-		
		0-9	-	-		
		0-12	-	-		
		0-16	-	-		
		-	13-1	-		
		-	to	-		
-	13-10	-				
3	L 13 /096a	0-3	-	-	Sep 10/01	
		0-7	-	-		
		0-9	-	-		
		2-5	-	-		
4	L 13 /098a	0-3	-	-	Jan 25/02	
		0-7	-	-		
		0-9	-	-		
		3-14	-	-		
5	L 13 AC/006d	0-3	-	-	Feb 11/02	
		0-7	-	-		
		to	-	-		
		0-14	-	-		
		1-4	-	-		
		1-5	-	-		
		1-6	-	-		
		-	1-7	-		
		-	1-8	-		
		3-5	-	-		
		3-7	-	-		
		3-10	-	-		
		3-13	-	-		
		3-14	-	-		
3-15	-	-				
3-17	-	-				

L - 13 AC BLANIK

MAINTENANCE MANUAL

Serial. No. of revision	Number of bulletin L 13 AC...	Numbers of Pages			Date of Revision	Date of insertion in this issue and signature
		Rev. Pages	New. Pages	Del. Pages		
5	L 13 AC/006d	3-18	-	-	Feb 11/02	
		3-25	-	-		
		3-30	-	-		
		5-3	-	-		
		to	-	-		
		5-7	-	-		
		5-15	-	-		
		to	-	-		
		5-20	-	-		
		-	5-21	-		
		-	5-22	-		
		7-3	-	-		
		7-4	-	-		
		7-17	-	-		
		8-5	-	-		
8-8	-	-				
6	L 13 AC/011a	0-3	-	-	June 6/02	
		0-8	-	-		
		0-9	-	-		
		0-11	-	-		
		0-12	-	-		
		0-15	-	-		
		9-3	-	-		
		9-24	-	-		
		-	9-25	-		
		-	9-26	-		

LIST OF EFFECTIVE PAGES

Chapter	Page	Date	Chapter	Page	Date	
Title page	-	-	3 Servicing	3 - 9	June 30/98	
0 General	0 - 1	June 30/98		3 - 10	Feb 11/02	
	0 - 2	June 30/98		3 - 11	June 30/98	
Record of issued bulletins	0 - 3	June 6/02		3 - 12	June 30/98	
	0 - 4	June 30/98		3 - 13	Feb 11/02	
Record of temporary revisions	0 - 5	June 30/98		3 - 14	Feb 11/02	
	0 - 6	June 30/98		3 - 15	Feb 11/02	
Record of revisions	0 - 7	Feb 11/02		3 - 16	June 30/98	
	0 - 8	June 6/02		3 - 17	Feb 11/02	
List of effective pages	0 - 9	June 6/02		3 - 18	Feb 11/02	
	0 - 10	Feb 11/02		3 - 19	June 30/98	
	0 - 11	June 6/02		3 - 20	June 30/98	
	0 - 12	June 6/02		3 - 21	June 30/98	
Table of contents	0 - 13	Feb 11/02		3 - 22	June 30/98	
	0 - 14	Feb 11/02		3 - 23	June 30/98	
	0 - 15	June 6/02		3 - 24	June 30/98	
	0 - 16	Aug 15/01		3 - 25	Feb 11/02	
1 Introduction	1 - 1	June 30/98		3 - 26	June 30/98	
	1 - 2	June 30/98		3 - 27	June 30/98	
	1 - 3	June 30/98		3 - 28	June 30/98	
	1 - 4	Feb 11/02		3 - 29	Feb 18/00	
	1 - 5	Feb 11/02		3 - 30	Feb 11/02	
	1 - 6	Feb 11/02		3 - 31	June 30/98	
	1 - 7	Feb 11/02		3 - 32	June 30/98	
	1 - 8	Feb 11/02		4 Fuselage	4 - 1	June 30/98
2 Inspections	2 - 1	June 30/98			4 - 2	June 30/98
	2 - 2	June 30/98			4 - 3	June 30/98
	2 - 3	June 30/98			4 - 4	June 30/98
	2 - 4	June 30/98			4 - 5	June 30/98
	2 - 5	Sep 10/01			4 - 6	June 30/98
	2 - 6	June 30/98			4 - 7	June 30/98
	2 - 7	June 30/98			4 - 8	June 30/98
	2 - 8	June 30/98	4 - 9		June 30/98	
	2 - 9	June 30/98	4 - 10		June 30/98	
	2 - 10	June 30/98	4 - 11		June 30/98	
3 Servicing	3 - 1	June 30/98	4 - 12		June 30/98	
	3 - 2	June 30/98	4 - 13		June 30/98	
	3 - 3	June 30/98	4 - 14		June 30/98	
	3 - 4	June 30/98	4 - 15		June 30/98	
	3 - 5	Feb 11/02	4 - 16		June 30/98	
	3 - 6	June 30/98	4 - 17		June 30/98	
	3 - 7	Feb 11/02	4 - 18		June 30/98	
	3 - 8	June 30/98	4 - 19		June 30/98	
			4 - 20		June 30/98	
			4 - 21		June 30/98	
			4 - 22		June 30/98	
			4 - 23		June 30/98	
			4 - 24		June 30/98	
			4 - 25		June 30/98	
			4 - 26		June 30/98	
			4 - 27		June 30/98	

Chapter	Page	Date
4 Fuselage	4 - 28	June 30/98
	4 - 29	June 30/98
	4 - 30	June 30/98
	4 - 31	June 30/98
	4 - 32	June 30/98
	4 - 33	June 30/98
	4 - 34	June 30/98
	4 - 35	June 30/98
	4 - 36	June 30/98
5 Wing	5 - 1	June 30/98
	5 - 2	June 30/98
	5 - 3	Feb 11/02
	5 - 4	Feb 11/02
	5 - 5	Feb 11/02
	5 - 6	Feb 11/02
	5 - 7	Feb 11/02
	5 - 8	June 30/98
	5 - 9	June 30/98
	5 - 10	June 30/98
	5 - 11	June 30/98
	5 - 12	June 30/98
	5 - 13	June 30/98
	5 - 14	June 30/98
	5 - 15	Feb 11/02
	5 - 16	Feb 11/02
	5 - 17	Feb 11/02
	5 - 18	Feb 11/02
	5 - 19	Feb 11/02
	5 - 20	Feb 11/02
	5 - 21	Feb 11/02
	5 - 22	Feb 11/02
6 Tail unit	6 - 1	June 30/98
	6 - 2	June 30/98
	6 - 3	June 30/98
	6 - 4	June 30/98
	6 - 5	June 30/98
	6 - 6	June 30/98
	6 - 7	June 30/98
	6 - 8	June 30/98
	6 - 9	June 30/98
	6 - 10	June 30/98
	6 - 11	June 30/98
	6 - 12	June 30/98
	6 - 13	June 30/98
	6 - 14	June 30/98
	6 - 15	June 30/98
	6 - 16	June 30/98
	6 - 17	June 30/98
	6 - 18	June 30/98
7 Controls	7 - 1	June 30/98
	7 - 2	June 30/98
	7 - 3	Feb 11/02

Chapter	Page	Date
7 Controls	7 - 4	Feb 11/02
	7 - 5	June 30/98
	7 - 6	June 30/98
	7 - 7	June 30/98
	7 - 8	June 30/98
	7 - 9	June 30/98
	7 - 10	June 30/98
	7 - 11	June 30/98
	7 - 12	June 30/98
	7 - 13	June 30/98
	7 - 14	June 30/98
	7 - 15	June 30/98
	7 - 16	June 30/98
	7 - 17	Feb 11/02
	7 - 18	June 30/98
	7 - 19	June 30/98
	7 - 20	June 30/98
	7 - 21	June 30/98
	7 - 22	June 30/98
	7 - 23	June 30/98
	7 - 24	June 30/98
	7 - 25	June 30/98
	7 - 26	June 30/98
	7 - 27	June 30/98
	7 - 28	June 30/98
	7 - 29	June 30/98
	7 - 30	June 30/98
8 Landing gear	8 - 1	June 30/98
	8 - 2	June 30/98
	8 - 3	June 30/98
	8 - 4	June 30/98
	8 - 5	Feb 11/02
	8 - 6	June 30/98
	8 - 7	June 30/98
	8 - 8	Feb 11/02
	8 - 9	June 30/98
	8 - 10	June 30/98
	8 - 11	June 30/98
	8 - 12	June 30/98
	8 - 13	June 30/98
	8 - 14	June 30/98
	8 - 15	June 30/98
	8 - 16	June 30/98
	8 - 17	June 30/98
	8 - 18	June 30/98
	8 - 19	June 30/98
	8 - 20	June 30/98
	8 - 21	June 30/98
	8 - 22	June 30/98
	8 - 23	June 30/98
	8 - 24	June 30/98
	8 - 25	June 30/98
	8 - 26	June 30/98
	8 - 27	June 30/98

Chapter	Page	Date
8 Landing gear	8 - 28	June 30/98
	8 - 29	June 30/98
	8 - 30	June 30/98
9 Furnishing and equipment	9 - 1	June 30/98
	9 - 2	June 30/98
	9 - 3	June 6/02
	9 - 4	June 30/98
	9 - 5	June 30/98
	9 - 6	June 30/98
	9 - 7	June 30/98
	9 - 8	June 30/98
	9 - 9	June 30/98
	9 - 10	June 30/98
	9 - 11	June 30/98
	9 - 12	June 30/98
	9 - 13	June 30/98
	9 - 14	June 30/98
	9 - 15	June 30/98
	9 - 16	June 30/98
	9 - 17	June 30/98
	9 - 18	June 30/98
	9 - 19	June 30/98
	9 - 20	June 30/98
	9 - 21	June 30/98
	9 - 22	June 30/98
	9 - 23	June 30/98
	9 - 24	June 6/02
	9 - 25	June 6/02
	9 - 26	June 6/02
10 Instruments and parts of electric equipment	10 - 1	June 30/98
	10 - 2	June 30/98
	10 - 3	June 30/98
	10 - 4	June 30/98
	10 - 5	June 30/98
	10 - 6	June 30/98
	10 - 7	June 30/98
	10 - 8	June 30/98
	10 - 9	June 30/98
	10 - 10	June 30/98
	10 - 11	June 30/98
	10 - 12	June 30/98
	10 - 13	June 30/98
	10 - 14	June 30/98
	10 - 15	June 30/98
	10 - 16	June 30/98
	10 - 17	June 30/98
	10 - 18	June 30/98
	10 - 19	June 30/98
	10 - 20	June 30/98
	10 - 21	June 30/98
	10 - 22	June 30/98
	10 - 23	June 30/98
	10 - 24	June 30/98

Chapter	Page	Date
10 Instruments and parts of electric equipment	10 - 25	June 30/98
	10 - 26	June 30/98
	10 - 27	June 30/98
	10 - 28	June 30/98
	10 - 29	June 30/98
	10 - 30	June 30/98
	11 Repairs	11 - 1
11 - 2		June 30/98
11 - 3		June 30/98
11 - 4		June 30/98
11 - 5		June 30/98
11 - 6		June 30/98
11 - 7		June 30/98
11 - 8		June 30/98
11 - 9		June 30/98
11 - 10		June 30/98
11 - 11		June 30/98
11 - 12		June 30/98
11 - 13		June 30/98
11 - 14		June 30/98
11 - 15		June 30/98
11 - 16		June 30/98
11 - 17		June 30/98
11 - 18		June 30/98
11 - 19		June 30/98
11 - 20		June 30/98
11 - 21		June 30/98
11 - 22		June 30/98
11 - 23		June 30/98
11 - 24		June 30/98
11 - 25		June 30/98
11 - 26		June 30/98
11 - 27		June 30/98
11 - 28		June 30/98
11 - 29		June 30/98
11 - 30		June 30/98
11 - 31		June 30/98
11 - 32		June 30/98
11 - 33		June 30/98
11 - 34		June 30/98
11 - 35		June 30/98
11 - 36		June 30/98
12 Appendices	12 - 1	June 30/98
	12 - 2	June 30/98
	12.1 - 1	June 30/98
	12.1 - 2	June 30/98
	12.2 - 1	June 30/98
	12.2 - 2	June 30/98
	12.3 - 1	June 30/98
	12.3 - 2	June 30/98
	12.3 - 3	June 30/98
	12.3 - 4	June 30/98
12.3 - 5	June 30/98	



L - 13 AC BLANIK

MAINTENANCE MANUAL

Chapter	Page	Date
12 Appendices	12.3 - 6	June 30/98
	12.4 - 1	June 30/98
	12.4 - 2	June 30/98
	12.4 - 3	June 30/98
	12.4 - 4	June 30/98
	12.5 - 1	June 30/98
	12.5 - 2	June 30/98
	13 Supplements	13 - 1
13 - 2		Aug 15/01
13 - 3		Aug 15/01
13 - 4		Aug 15/01
13 - 5		Aug 15/01
13 - 6		Aug 15/01
13 - 7		Aug 15/01
13 - 8		Aug 15/01
13 - 9		Aug 15/01
13 - 10		Aug 15/01

Chapter	Page	Date

7.4.	LONGITUDINAL CONTROL	7 - 7
7.5.	AIR BRAKES CONTROL	7 - 12
7.6.	SERVICING	7 - 14
7.7.	REMOVAL / INSTALLATION	7 - 20
7.8.	COMMON REPAIRS	7 - 23
8.	LANDING GEAR	8 - 1
8.1.	LANDING GEAR	8 - 3
8.2.	MAIN LANDING GEAR	8 - 3
8.3.	AUXILIARY LANDING GEAR	8 - 3
8.4.	WHEELS AND BRAKES	8 - 5
8.5.	LANDING GEAR SHOCK ABSORBER	8 - 9
8.6.	RETRACTION AND EXTENSION OF LANDING GEAR	8 - 12
8.7.	SERVICING	8 - 14
8.8.	REMOVAL / INSTALLATION	8 - 21
8.9.	ADJUSTING / TESTING	8 - 27
8.10.	COMMON REPAIRS	8 - 27
9.	EQUIPMENT AND FURNISHINGS	9 - 1
9.1.	EQUIPMENT AND FURNISHINGS	9 - 3
9.2.	INSTRUMENT PANELS AND CONTROL PANELS	9 - 3
9.3.	COCKPIT VENTILATION	9 - 6
9.4.	COCKPIT FURNISHINGS	9 - 8
9.5.	EMERGENCY EQUIPMENT	9 - 10
9.6.	SYSTEM OF TOTAL, STATIC AND COMPENSATED PRESSURE	9 - 10
9.7.	LUN 1211.1 TURN-AND-BANK INDICATOR INSTALLATION	9 - 13
9.8.	LUN 1221.1-8 LIQUID COMPASS INSTALLATION	9 - 13
9.9.	AM-10 ACCELEROMETER INSTALLATION	9 - 13
9.10.	NiCd BATTERY INSTALLATION	9 - 14
9.11.	VHF TRANSCEIVER INSTALLATION	9 - 14
9.12.	ELECTRICAL BONDING AND GROUNDING	9 - 14
9.13.	SERVICING	9 - 16
9.14.	REMOVAL / INSTALLATION	9 - 21
9.15.	INSPECTION / CHECK	9 - 23
9.16.	COMMON REPAIRS	9 - 24
9.17.	EQUIPMENT / FURNISHING LIST	9 - 24
10.	INSTRUMENTS AND PARTS OF ELECTRICAL EQUIPMENT	10 - 1
10.1.	LUN 1106.14-8 AIRSPEED INDICATOR	10 - 3

10.2.	LUN 1124.01-8 OR UI 5934P-3 ALTIMETER	10 - 5
10.3	LUN 1147.23-8 VERTICAL SPEED INDICATOR	10 - 7
10.4.	LUN 1141.04 VERTICAL SPEED INDICATOR	10 - 8
10.5.	D 000 085 N MOISTURE TRAP	10 - 9
10.6.	LUN 1211.1 TURN-AND-BANK INDICATOR	10 - 10
10.7.	LUN 1221.1-8 LIQUID TYPE COMPASS	10 - 11
10.8.	AIRBORNE BATTERY	10 - 14
10.9.	AM-10 ACCELEROMETER	10 - 15
10.10.	} RESERVED	
10.11.		
10.12.	SERVICING	10 - 16
10.13.	REMOVAL / INSTALLATION	10 - 22
10.15.	INSPECTION / CHECK	10 - 25
11.	REPAIRS	11 - 1
11.1.	REPAIRS	11 - 3
11.2.	REPAIRS OF PAINT COATS	11 - 3
11.3.	SKINS REPAIRS	11 - 5
11.4.	REMOVAL OF CORROSION OF ELECTRON LIGHT METAL PARTS CORROSION	11 - 22
11.5.	ELIMINATION OF BACKLASH IN CONTROLS	11 - 23
11.6.	REPAIRS OF ELECTRICAL SYSTEM	11 - 24
11.7.	CONTROL SURFACE SERVICE REPAIRS FROM THE POINT OF VIEW OF SAFETY AGAINST FLUTTER	11 - 29
12.	APPENDICES	12 - 1
12.1.	LIST OF ASSEMBLY DRAWINGS	12.1 - 1
12.2.	LIST OF PARTS SUBJECT TO DYE PENETRANT NDT	12.2 - 1
12.3.	CONVERSION TABLES OF USED MATERIALS	12.3 - 1 to 12.3 - 5
12.4.	SAILPLANE TEST FLIGHT	12.4 - 1 to 12.4 - 3
12.5.	SPARE PARTS STORAGE	12.5 - 1
13.	SUPPLEMENTS	13 - 1
13.1.	INTRODUCTION	13 - 3
13.2.	LIST OF SUPPLEMENTS	13 - 3

9.1. EQUIPMENT AND FURNISHINGS

Equipment / furnishing list - see section 9.17.

The instrumentation includes the instruments and the control elements which serve to the flight crew for the control of the sailplane and for the evaluation of the flight mode.

The flight instruments provide the flight crew with the data of the sailplane attitude and the flight direction.

The flight instrument system consists of the instruments utilizing the changes of the pressure in dependence of the altitude and airspeed, and of the instruments utilizing the earth magnetic field.

The turn-and-bank indicator and the liquid compass belong to the system of instruments which give the data about the attitude and the direction of flight.

The accelerometer is installed to provide information on the overloads acting on the sailplane in the direction normal to the wing area.

It is possible to install the NiCd battery and VHF transceiver into the special equipment on request of the customer.

9.2. INSTRUMENT PANELS AND CONTROL PANELS

9.2.1. General

The instruments and the control elements necessary for the sailplane control are situated on the instrument panels and the control panels in the cockpit.

9.2.2. Front instrument panel

The front instrument panel is situated between the frames No.1 and 2 and it is attached in three points to the instrument panel glareshield. The instrument panel glareshield is screwed on the oblique frame No.1f.

The spring mounting of the instrument panel is carried out with the rubber shock absorbers at the locations of the attachment bolts.

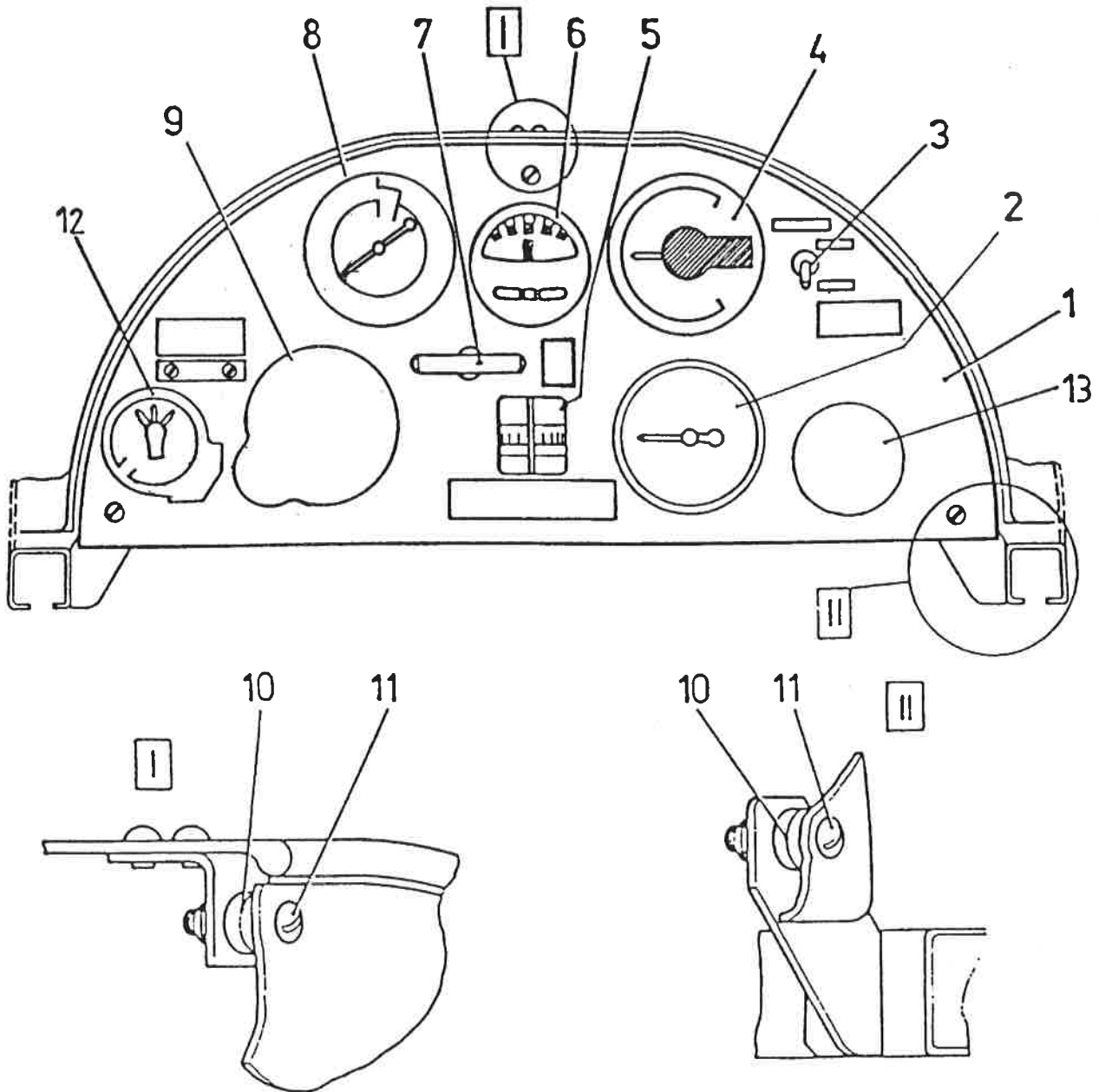

FIG. 9.2-1 FRONT INSTRUMENT PANEL
Legend to Figure - see following page.

- | | |
|----------------------------|---------------------------|
| C. Tooling | spanners from tooling set |
| D. Referenced information | none |
| E. Technological procedure | |

Remove the back-rests of the front and rear seats. Before removal of the front seat back rest remove the front seat (1) which lies unattached on the floor stiffeners. Then slide out the arresting strap (10) from the rack (18), slide out the bolts from the guideways (7). by means of the control levers (9) of the positioning mechanism (9), and push the back-rest (2) forward (in the direction of flight) out of the guideways.

Unlock and remove two bolts with washers to remove the back-rest of the rear seat.

Carry out the installation of both back-rests in the opposite way.

9.15. INSPECTION / CHECK

9.15.1. Leakage test of total, static and compensated pressure system

- | | |
|---|--|
| A. Aids, testing and additional equipment | equipment for generation of pressure with connected check airspeed indicator |
| B. Material | not required |
| C. Tooling | not required |
| D. Referenced information | 2.2.3.
periodical maintenance
(inspection 3,4) |
| E. Technological procedure | |

By means of the equipment for generation of the positive pressure with connected check airspeed indicator, generate positive pressure corresponding to the airspeed of 210.50 knots (390 km/h) according to the reading of the check airspeed indicator, in the total pressure system line. The pressure must not drop for 5 minutes.

By means of the equipment for generation of the positive pressure with connected check airspeed indicator, generate positive pressure corresponding to the airspeed of 210.50 knots (390 km/h) according to the reading of the check airspeed indicator, in the static and compensated pressure system line. The pressure drop must not exceed 10 km/h within 2 minutes.

Disconnect the equipment for pressure generation after performed test, remove the blinding plugs and connect the lines of the total, static and compensated pressure to the instruments on the front and rear instrument panels in compliance with the diagram in Fig. 9.6-1.

9.16. COMMON REPAIRS

9.16.1. Repairs of system of total, static and compensated pressure

- | | |
|---|--------------------------|
| A. Aids, testing and additional equipment | not required |
| B. Material | pipes, hoses |
| C. Tooling | tooling from tooling set |
| D. Referenced information | none |
| E. Technological procedure | |

The tubing and the hoses of the total, static and compensated pressure system, the hose tails and the distribution pieces are not to be repaired. Only the replacement is carried out. If it is not possible to replace them by new ones, use the equivalent substitutes. The particular parts must pass the pressure test, i.e. withstand the pressure of 22.45 psi (2 kp/cm²) for 5 minutes.

9.17. EQUIPMENT / FURNISHING LIST

The following equipment / furnishing is approved for using on the sailplane.

9.17.1. Minimum equipment

Conditions for operation, servicing, maintenance and repair and possible limitations contained in product certificates or technical specifications must be followed.

Altimeter:

Type	Manufacturer	Technical specification
LUN 1124.01-8	Mikrotechna-Modřany	TPF 01-3601-82
UI 5934P-3	United Instruments, USA	Code A83 TSO C10b

Airspeed indicator:

Type	Manufacturer	Technical specification
LUN 1106.14-8	Mikrotechna-Modřany	TPF 01-3028-61

Safety belts:

Type	Manufacturer	Technical specification
Bagu 5202	GADRINGER	
Schugu 2700	GADRINGER	
Bogu 1400	GADRINGER	

CAUTION: GADRINGER SAFETY BELTS - SERVICE LIFE IS 12 YEARS.

Accelerometer:

Type	Manufacturer	Technical specification
AM 10	Let. přístroje Praha	TPF 01-62

9.17.2. Optional equipment

Liquid type compass:

Type	Manufacturer	Technical specification
LUN 1221.1-8	Let. přístroje Praha	TPF 01-3295-69

Turn-and-bank indicator:

Type	Manufacturer	Technical specification
LUN 1211.1	Let. přístroje Praha	TPF 0177-04-59

Vertical speed indicator:

Type	Manufacturer	Technical specification
LUN 1141.04	Mikrotechna-Modřany	TPF 0021-04-55
LUN 1147.23-8	Mikrotechna-Modřany	TPF 01-3025-60

Transceiver:

Conditions for operating, servicing, maintenance and repair and possible limitations contained in product certificates must be followed.

Type	Manufacturer	Technical specification
LS-5	TESLA Kolín	TPTE 13-053/77
AR 4201	Becker	10.911/87
TERRA TX 760 D	TERRA, Austin, Texas	
FSG 71M	W. Dittel GmbH, Germany	10.911/81

Launching hooks:

Type	Manufacturer	Technical specification
TOST G 88/1-83 Lower hook	TOST GmbH, Germany	
TOST E 85/1-85 Forward hook	TOST GmbH, Germany	
A 001 023 L A 001 023 P Side hooks	LETECKÉ ZÁVODY a.s.	

L - 13 AC BLANIK

MAINTENANCE MANUAL

INTENTIONALLY LEFT BLANK